

1.

Lista komponentów:

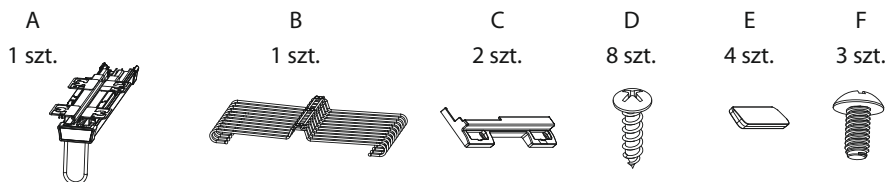

2.

Specyfikacja i odpowiednia szerokość szafki:

wymiary (W*D*H) mm
650x460x135 mm

3.

Wskazówki montażowe:

(1) Dla lepszego dopasowania przewodnicy do górnej płyty, zdemontuj najpierw wieszak B

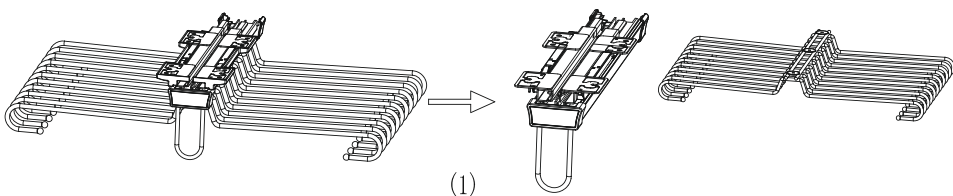

(2) Załóż osłony przewodnicy

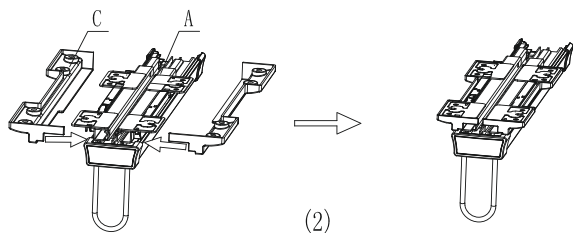

3.

(3) Wywierć otwory pod górną płytą

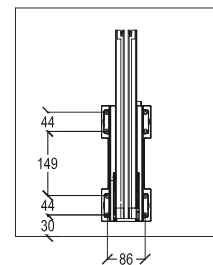

(3)

(4) Przymocuj przewodnicę do górnej płyty

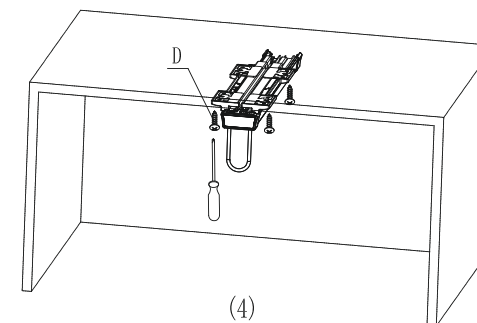

(5) Przykręć wieszak do przewodnicy

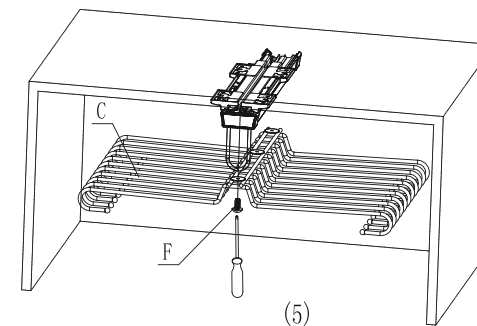

(6) Zamocuj zaślepki na otworach montażowych

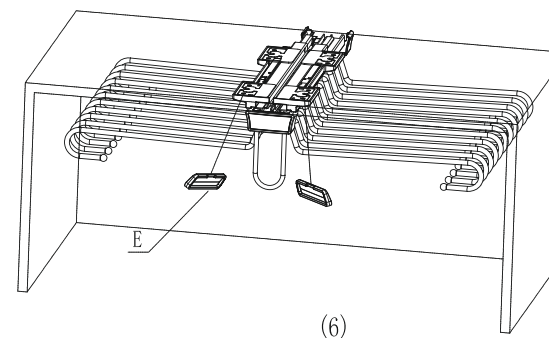

EX012 -Assembly Instruction



1.

Component List:

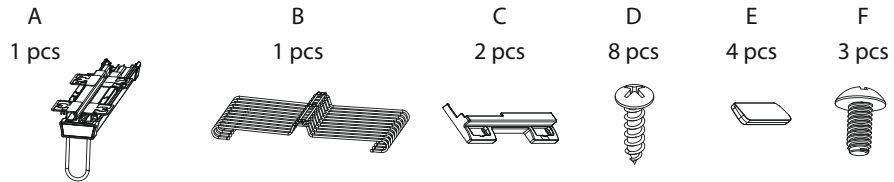

2.

Specification & applicable cabinet width:

specification (W*D*H) mm
650x460x135 mm

3.

Assembly steps:

(1) For better fixing the slides onto upper board, may disassemble the rack B firstly

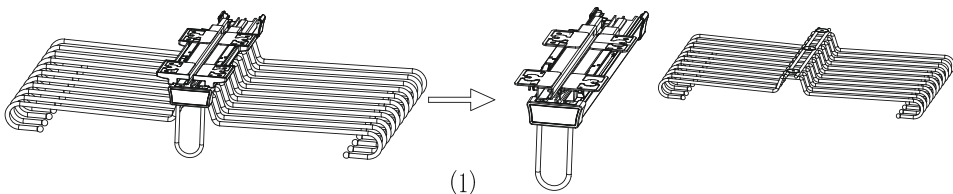

(2) Put on slides cover

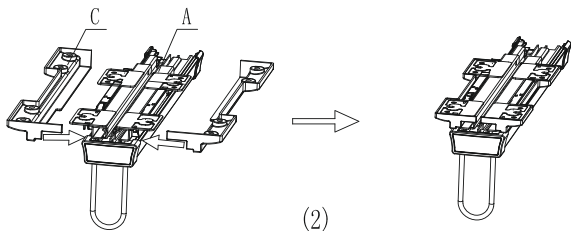

3.

(3) Screw holes size on the upper board

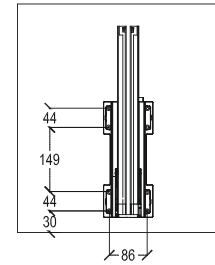

(3)

(4) Fix slides onto the upper board

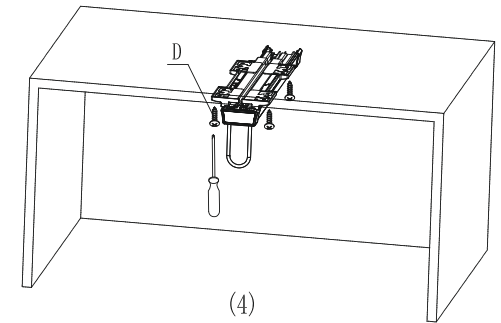

(4)

(5) Fasten the rack onto slides with screw

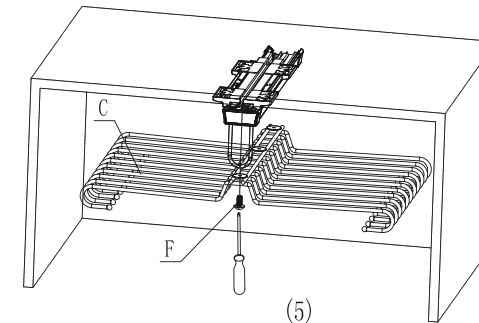

(5)

(6) Fix the screw covers onto the screw holes

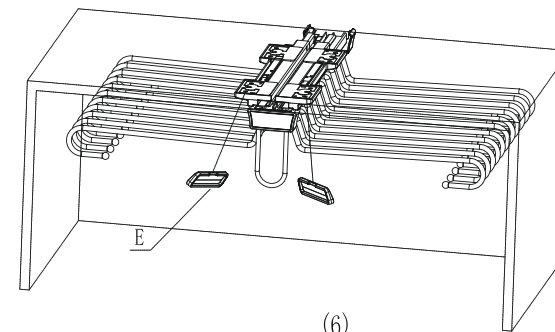

(6)